

## Solar Home System / HYBRID

### FEATURE

- Hi Performance with Smart MCU Control Technology
- Pure Sine Wave for useful application load.
- Convenient Output 5VDC USB port & 12Vdc port
- Solar Array for MPPT 30A Charger AGM / LFP
- AC Charge flexible Grid & Gen
- Overcharge protection and overdischarge protection for a longer battery life
- Fully Display LCD & LED for operation
- SHS : Solar Home System, Solar Standalone
- Overall Automatic Protection and Alarms Including AC output over load protection, short circuit protection, etc.

### SOLAR HOME SYSTEM / HYBRID



### PRODUCT OVERVIEW

1. Product Applies AC Pure Sine Wave for useful load Application with High Inrush Current Excellent Overload Protection
2. PV Solar Cell provide MPPT 30A solar three-stage charge management to improve charge efficiency of its battery and realize longer life
3. Product provides AC/DC Supply Load in AC universal Plug 5VDC USB and 12VDC Port and applied to small solar power generation occasions including Home, schools, Country Power Gen for, industrial and Small Equipment Station, Remoted Monitoring

### PRODUCT INFORMATION

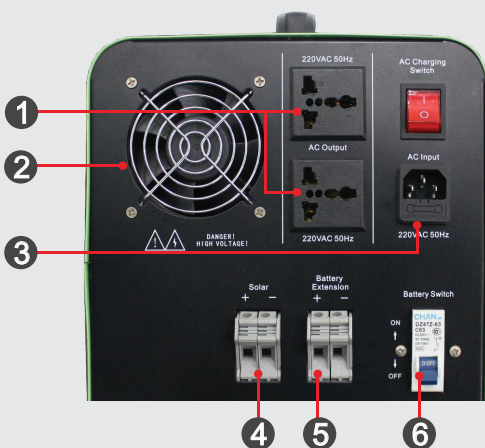

**Built-In Battery AGM/ LFP**

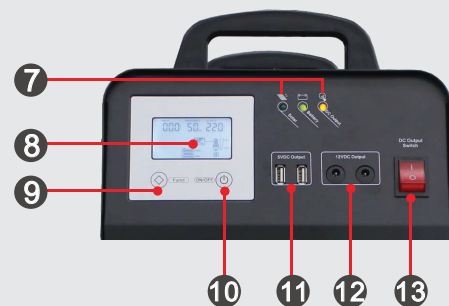

- |                      |                      |
|----------------------|----------------------|
| 1. AC Output         | 8. Fully LCD Display |
| 2. Smart Cooling Fan | 9. Function Buttons  |
| 3. AC Input          | 10. ON/OFF Buttons   |
| 4. Solar PV Input    | 11. 5V USB Port      |
| 5. Battery Extension | 12. 12VDC Port       |
| 6. Battery MCB       | 13. DC Output Switch |
| 7. LED Status        |                      |

## Solar Home System SHS

### specification

Model.	SHS 300	SHS 500	SHS 800	SHS 1000	SHS1000B	SHS1500B	SHS2000B
Technology	Offline Hybrid Inverter with 30A MPPT Charger						
Battery System	Batt : 12.0V				Batt : 24.0V		
Battery Built-In AGM Lithium LiFePO4 LFP	12.0V 50-100Ah 12.8V 50-100Ah		12.0V 100-200Ah 12.8V 100-200Ah		24.0V 50-100Ah 25.6V 50-100Ah		24.0V 100-200Ah 25.6V 100-200Ah
Rated Power	300W	500W	800W	1000W	1000W	1500W	2000W
Output Voltage	220VAC $\pm$ 2% / AC Bypass Grid / Gen						
Output Frequency	50/60Hz $\pm$ 1%						
Output Waveform	Pure Sine Wave (THDv <3%)						
AC Charge by Grid Line / Gen							
Input voltage	220VAC $\pm$ 10% 50/60 $\pm$ 10%Hz						
Charge current	AC : 10/20A						
PV Solar Cell input							
Maximum Power(Wp)	360Wp		720Wp				1000Wp
Maximum Photovoltaic (PV Solar) voltage(VDC)	$\leq$ 25V				$\leq$ 50V		
Charge voltage(VDC)	10-15V				20-30V		
PV charge	MPPT 30A with 3-state Buck-Boost-Float						
Voltage of overcharge protection (VDC)	14.2V				28.4V		
Voltage of overcharge recovery(VDC)	14.0V				28.0V		
Voltage of floating charge (VDC)	13.7V				27.4V		
DC Bus							
High-voltage protection	16.0V				32.0V		
High voltage recovery	15.2V				30.4V		
Low voltage recovery	12.6V				25.2V		
Low voltage protection	11.0V				22.0V		
5V USB port	2 USB Port 2A						
12VDC output port	2DC ports + backboard 12V Terminal Block (MAX 8A)						
Starting FAN temperature	>45°C						
Ambient Temperature	0-40°C						
Storage Temperature	-25 - +55°C						
Humidity / Sea Level	RH 0-90% (condensation) / Less than 1000m						
External dimensions : DxWxH (mm)	343x225x443		423x260x453				513x310x493
Packing dimension : DxWxH (mm)	420x290x490		520x370x520				610x420x550

CHU-EN.BRO-73.SHS.Rev1.00/2022

บริษัท เอ็นเนอร์ยี่ เวฟ จำกัด

949 หมู่ 9 ต.ลำโรงเหนือ อ.เมืองสมุทรปราการ จ.สมุทรปราการ 10270  
 โทรศัพท์: 02 186 3010 แฟกซ์: 02 186 3018-9 มือถือ: 092 926 1935  
 www.ewavethai.com  
 E-mail: 02@ewavethai.com

ตัวแทนจำหน่าย :